

ELBOW DESCRIPTION	RADIUS
1" - 90° OR 45°	18"
2.5" - 90° OR 45°	24"
3" - 90° OR 45°	24"
4" - 90° OR 45°	36"
6" - 90° OR 45°	48"

METER BASE SIZE	CONDUIT SIZE
200 - 320 AMP	3"
400 - 600	4"
600 - UP	CONTACT CEC

**NOTES:**

1. CUSTOMER FACILITIES SHALL COMPLY WITH THE NATIONAL ELECTRICAL CODE AND AUTHORITIES HAVING JURISDICTION.
2. METER SOCKET SHALL BE INSTALLED AND MAINTAINED BY THE CUSTOMER.
3. CONDUIT SYSTEM SHALL BE INSTALLED TO SECONDARY PED. CONSULT CEC FOR SPECIFIC LOCATION.
4. CEC TO INSTALL SERVICE CONDUCTORS.
5. MAXIMUM LENGTH OF CONDUIT INCLUDING ABOVE GRADE SECTION NOT TO EXCEED 250'
6. CONTACT CEC FOR INSPECTION OF CONDUIT INSTALLATION PRIOR TO BACK-FILLING TRENCH.
7. BACK-FILL AND TAMP TRENCH AFTER CONDUIT INSPECTION TO 95% PROCTOR DENSITY.
8. WARNING TAPE TO BE INSTALLED DURING BACK-FILL AT 12" DEPTH.
9. RESET AND SECURE SECONDARY PEDESTAL AS NEEDED AFTER OPENING TRENCH.
10. CONDUIT SHALL BE ELECTRICAL GRADE SCHEDULE 40 PVC OF SIZE SPECIFICATION.

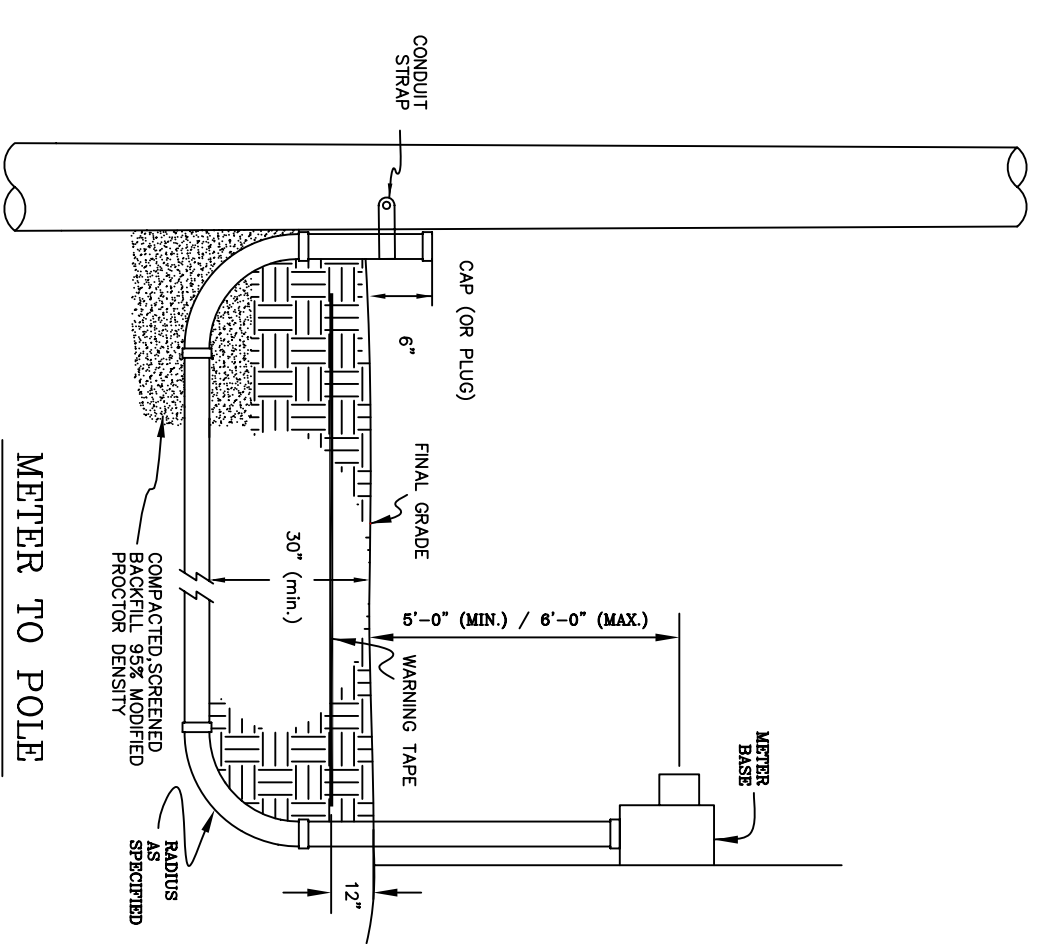

**METER TO SECONDARY PEDESTAL**

**METER TO POLE**

**REVISIONS**

FILE NO.:



**COASTAL ELECTRIC COOPERATIVE  
SERVICE CONDUIT INSTALLATION GUIDE**

DATE: 6-12-06 DRAWN BY: CJH APPROVED BY: JWM